

Specialists in Timber Windows

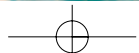



Specialists in Timber Windows

TRC Contract Services specialise in the design, manufacture and installation of timber windows.

All window systems are manufactured in an ISO9001 registered factory and meet the performance requirements of BS6375, BS5268 and BS5368 for wind resistance, weather-tightness, operation, strength and air-permeability. Windows are also tested to BS7590 for enhanced security.

Our windows conform to part L of building regulations by using sealed unit glazing with low E coating and argon filled cavities for increased warmth and comfort.

The management for all timber window projects is supported by stringent quality control procedures. These are regularly assessed and checked throughout a contract period. Qualified professionals carry out all work using the highest quality materials and the latest technology available.

TRC Contract Services' success is built on uncompromising customer service from fully trained experienced staff, backed by a management team committed to long lasting relationships.

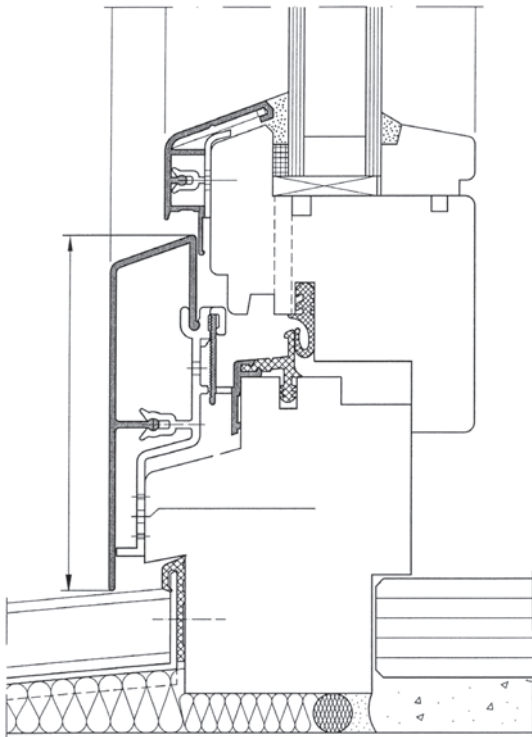

Profile of a timber window with aluminium cladding

Our Work



Railstore

William Verry Ltd awarded the design, manufacture and installation of the windows and lanterns to TRC Contract Services. The prestigious refurbishment of the heritage building in Romford Essex, saw these two listed railway buildings converted into apartments.



Our Product Range

TRC Contract Services offer a 10 year insurance backed guarantee as standard on all windows. This guarantee is offered in addition to your statutory rights.



Softwood

TRC Contract Services use engineered softwoods taken from sustainable sources. These windows provide excellent weather resistance and are available in any softwood required.

Hardwood

The hardwood windows can be made from any timber specified, which creates a high quality finish and an extremely durable product.

Aluminium Clad

Aluminium clad outer frames are available in the full RAL colour range. The aluminium outer is powder coated giving a tough weather resistant exterior, whilst the timber inner gives a warm natural finish. We can also provide matching wall cladding.



St Josephs Primary School, Maida Vale

TRC Contract Services were awarded the contract on this school extension by ACP architects. ACP chose aluminium clad windows as this range provided the flexibility required whilst being low maintenance, high security and excellent value for money. The contract included fully integrated doors, opening windows and screens and circular windows. A complex part of the project required TRC Contract Services to design, create and install a modern entrance to the building with a curved display area.



Specialists in Timber Windows

Windows and doorsets



Windows and doorsets can include a variety of glazing units:

- Insulated glazing units (using selective coatings)
- Solar control, reflective (mirror) glazing units
- Acoustic glazing units
- Laminated glazing units
- Fire-resistant glazing units
- Tinted, frosted and obscure units
- Safety glazing units (toughened)

U values

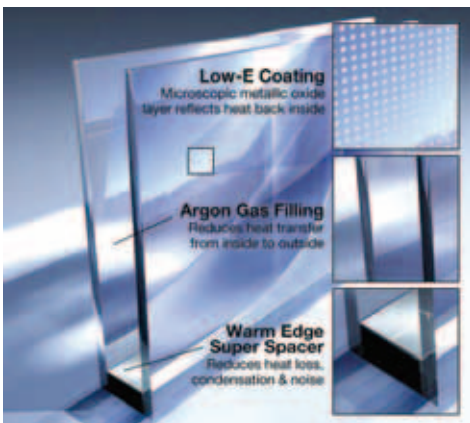

Whole window U values (including edge effects and frame)

- Double glazed
- Standard 1.6 W/m²K
- With 'warm edge' spacers 1.3 W/m²K
- Triple glazed
- Standard 1.1 W/m²K
- With 'warm edge' spacers far exceeds 1.0 W/m²K
- Calculated to BS EN 10077 pt 1 & 2 – using BRE software

Hanworth House



London borough of Southwark

TRC carried out the supply, design and installation of over 800 timber tilt and turn windows to Hanworth House – the main contractor was Apollo and the client was the London borough of Southwark, the contract also involved the replacement of 1,500sq metres of cedar cladding and was carried out over a 10 month period.



Outward Opening Windows

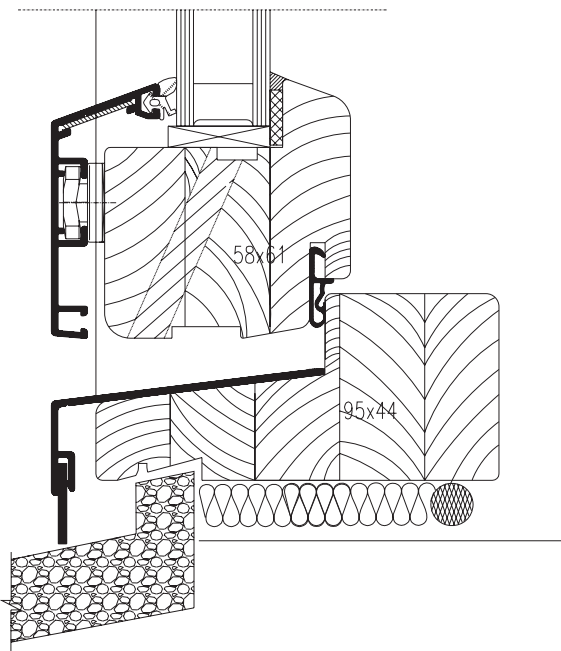

Main features

- Scandinavian redwood
- PN Combi profile/system
- Double glazing
- Wide colour palette – RAL colours
- Good thermal insulation
- Laminated timber
- Friction stays or fully reversing

Various styles

- Top Hung
- Projecting Top Hung
- Reversible
- Side Swing
- Projecting Side Hung
- Side Hung

Also available without aluminium cladding.

100%



The Trademark of the Forest Stewardship Council (FSC) indicates that the wood used to make the product comes from a forest which is well managed according to strict environmental, social and economic standards. The forest of origin has been independently inspected and evaluated according to the principles and criteria for forest management agreed and approved by the Forest Stewardship Council. FSC is an international, non-profit association whose membership comprises environmental and social groups and progressive forestry and wood retail companies working in partnership to improve forest management worldwide.

© 1996 Forestry Stewardship Council A.C



Specialists in Timber Windows

Inward Opening Windows

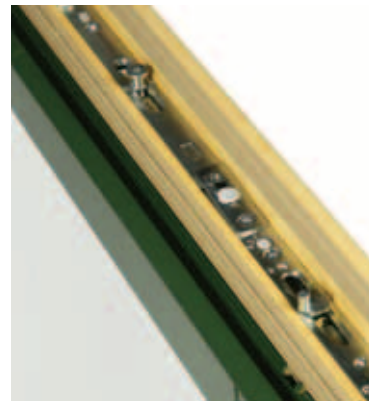

There are two timber window profiles available: 'EURO IV 68 SOFTLINE' (for double glazing) and 'EURO IV 78 SOFTLINE' (for triple glazing).

Private Residence



Cambridge

TRC not only undertake commercial and social housing projects, but are able to offer products that are suitable for private houses. This is a project we undertook in Cambridge with Timber/aluminium composite windows



Aluminium clad timber

High security hardware, hinges and hinge covers.

Aluminium cladding, protecting the timber beneath against the elements, pollution, and weathering.

Optional 'warm-edge' spacer.

Argon gas cavity fill. Double glazed window has a whole window U value of 1.6W/m²K. With triple glazing the whole window U value can be as low as 1.1 W/m²K.

Mitred corners give a neater finish to the cladding.

FSC 100% certified engineered timber.

Cladding secured with a proprietary clip system.

Microporous wood protection and finishing system. Totally water-based.

Cladding available in any RAL colour.

Dedicated jointing bolts ensure precise cladding connections.

The profiled aluminium drip rail gives additional protection against any possible moisture ingress.

The aluminium profile is designed to allow fully ventilated timber sections.



Our Clients Include:

Apollo Construction Ltd	Harlow Council	Persimmon Homes
Balfour Beatty Construction Ltd	HBG Construction Ltd	Pick Everard
Barratt Homes	Islington Council	Sandwell Metropolitan Borough Council
Berkeley Homes	Jesus Fellowship	Sindall Ltd
Birmingham City Council	John Ratcliffe Hospital	Southwark Council
Blue Print Estates	John Sisk	Stafford Borough Council
Borras Construction Ltd	Leicester City Council	St James Homes
Buckinghamshire County Council	Lengard Ltd	Swindon Borough Council
Camden Council	Mace	Teachers' Housing Association
Carrlion	Mansell Plc	Touchstone Housing
Crispin & Borst	Martin Ward & Keeling	Vale Housing Association
Crosby Homes	The Methodist Church	Weatherall Green & Smith
Enfield Council	Nansen Villiage	William Verry
Fairbriar Homes	NHS Trust	Willmot Dixon
G.F. Holding Contractors Ltd	Nicholas King Homes	Winchester Healthcare
Gateshead Council	Nilsson Design	YJL
George Wimpey	Overbury Plc	
Hackney Council	Parkeray	



TRC Contracts Ltd

Head Office: Unit 2 | Union Wharf | Market Harborough | LE16 7UW | T: 01858 469 225 | F: 01858 469 249

London Office: Bank Chambers | 29 High Street | Ewell | KT17 1SB | T: 0208 786 3613 | F: 0208 786 8887

W: www.trccontracts.com | E: headoffice@trccontracts.com